

NOTICE OF RECONSIDERATION WAS
GIVEN BY MR. MEYER 4-7-98

Reconsidered 4-14-98

Submitted by: Chairman of the Assembly at the
Request of the Mayor

Prepared by: Anchorage Water & Wastewater
Utility

For reading: January 6, 1998

CLERK'S OFFICE

AMENDED AND APPROVED

Date: 4-14-98

ANCHORAGE, ALASKA

AR NO. 98-6

**A RESOLUTION CONFIRMING AND LEVYING ASSESSMENTS FOR THE
SANITARY SEWER IMPROVEMENTS ON PROPERTY BENEFITED IN NE
TURNAGAIN LATERAL SEWER IMPROVEMENT DISTRICT NUMBER 101,
SETTING DATE OF PAYMENT AND PROVIDING FOR PENALTIES AND
INTEREST IN THE EVENT OF DELINQUENCY.**

THE ANCHORAGE ASSEMBLY RESOLVES:

SECTION 1. The lateral sewer improvements authorized in Ordinance AO 79-6 and AO 85-25 have been completed and costs for the improvements computed. Lateral and trunk sewer assessments are levied against the property benefited for said improvements as set forth on the attached assessment roll.

SECTION 2. Timely notice was sent to each property owner whose property is benefited by the improvements as indicated on the attached assessment roll. Each property owner was given notice of a public hearing to be held before the Municipal Assembly, for the purpose of giving the property owners an opportunity to present objections to the assessment roll by showing errors and inequalities in the assessment roll and submitting any reason for amendment and correction of the assessment roll for NE Turnagain Lateral Sewer Improvement District Number 101. In conformance with the notice to the property owners, the Municipal Assembly held a public meeting on April 7, 1998, to hear any objections to the assessment roll by property owners. At said hearing all errors and inequalities to which valid objections were raised were corrected and the amounts now indicated on the assessment roll are those amounts determined to be assessed. Said amounts are equal to, or less than, the direct benefit each property derives from the improvements constructed. The assessment roll has been duly certified by the Municipal Clerk.

SECTION 3. Assessments shall be paid in annual installments, in accordance with the Anchorage Wastewater Utility Tariff in effect at the time of levy. The first installment is due on November 30, 1998, and is payable on the same day of each subsequent year. Interest on unpaid installments starts to accrue on November 1, 1998. An installment payment shall be applied first to accrued interest then to principal. A penalty of eight percent (8%) shall be added to any assessment, or assessment installment, not paid before the date of delinquency. The assessment, installment and penalty shall draw interest at the rate of eight percent (8%) per annum until paid. For delinquencies, payment shall be applied in accordance with AMC 19.20.280.

SECTION 4. Within thirty (30) days after the ^{effective date} ~~passage~~ of this resolution, the Municipal Treasurer shall mail a notice to any owners of property whose

assessment, schedule of payments, delinquencies, or amount of penalty and interest has been changed as a result of the public hearing concerning this resolution. Not more than sixty (60) days nor less than thirty (30) days before the date the assessment or the first installment of the assessment becomes delinquent, the treasurer shall mail a payment notice to each property owner, but failure to mail the notice shall in no way affect the special assessment levied by this resolution.

SECTION 5. The Special Assessment Collection Charge, as authorized by AMC 19.20.265.B, and Section 7.4 of the Anchorage Wastewater Utility's Tariff, will be applied to those properties included within this resolution.

Section 6. See amendment below.

PASSED AND APPROVED by the Assembly of Anchorage this 14th day of April, 1998.

Chairman

ATTEST:

Municipal Clerk

Amendment approved April 14, 1998:

Section 6. The effective date of this resolution is established as July 14, 1998



to

ALL PARC LS 5 M ALASKA

REPORT NUMBER FSA045-A
OCTOBER 06, 1997

WATER AND WASTEWATER UTILITY
SEWER FINAL ASSESSMENTS FOR LID NUMBER 94101 N.E. TURNAGAIN LID #101

PAGE

PROJECT COST \$605,139.21
TRUNK RATE \$.0300000/SQ.FT.
LATERAL RATE \$1.6253711868/SQ.FT.
INTEREST RATE 07.320000%
PUC CALCULATION 021

| BOOK-PAGE-LOT | SQ/FT | | ASSESSMENT | TOTAL-ASMT | ANNUAL # OF PAYMENT PMTS | TOT-ANN PAYMENTS | FINAL PAYMENT | NAME ADDRESS |
|----------------|---------|-----------|------------|------------|-----------------------------|---------------------|------------------|-----------------|
| 001-132-91-000 | 45,002 | LAT: | 73,144.95 | 74,713.95 | 6,735.77 20 | | 6,735.77 | |
| BLK A LT 10B | | SVC CONN: | 1,569.00 | | | 7,231.13 | | |
| TURNAGAIN N E | 122,641 | TRUNK: | | 3,679.23 | 495.36 10 | | 495.36 | |

REPORT TOTALS FOLLOW

| | | | | | | | | |
|--------------|---------|-----------|------------|------------|-----------|----------|-----------|--|
| REPORT | 364,264 | LAT: | 592,064.18 | 605,139.18 | 54,555.79 | | 54,555.79 | |
| | | SVC CONN: | 13,075.00 | | | | | |
| TOTALS: | 801,828 | TRUNK: | | 24,054.84 | 7,365.95 | 1,921.74 | 7,365.95 | |
| TOTAL ITEMS: | 23 | | | | | | | |

ALL PARCELS S.M., ALASKA

001-132-91-000
BLK A LT 10B
TURNAGAIN N E

**COMBINED PW AWWU
SUMMARY ASSESSMENT ROLL FOR NE TURNAGAIN**

By: Mark S.
November 10, 1997

| PROPERTY DESCRIPTION | | | | | Public Works Street Improvement Costs | | | | Anchorage Water & Wastewater | | | TOTAL ASSMPTS |
|----------------------|-------------|----------------|-----|-----------|------------------------------------------|-----------|-------------------|-------------------|---------------------------------|----------------|------------|------------------|
| Tax ID | SUBDIVISION | Blk | Lot | | DIRECT COSTS REPLAT | SOILS | DELETION COSTS | RID COST TOTAL | Lateral Sewer | Trunk Sewer | Water | |
| 1 | 001-121-13 | TURNAGAIN N.E. | A | 1A1 | 2,414.36 | 10,000.0 | 19,869.54 | 53,128.51 | 24,715.02 | 1,209.60 | 12,857.37 | 91,910.50 |
| 2 | 001-121-14 | TURNAGAIN N.E. | A | 2A-1-1 | 3,238.42 | 10,000.0 | 23,841.58 | 62,091.57 | 29,498.49 | 1,622.46 | 16,607.61 | 109,820.13 |
| 3 | 001-121-15 | TURNAGAIN N.E. | A | 1B1 | 2,497.35 | 10,000.0 | 23,795.04 | 61,255.14 | 22,026.66 | 1,251.18 | 9,797.98 | 94,330.96 |
| 4 | 001-121-16 | TURNAGAIN N.E. | A | 1C1 | 2,681.48 | 0.0 | 36,661.57 | 77,803.71 | 22,680.06 | 1,343.43 | 9,644.01 | 111,471.21 |
| 5 | 001-121-17 | TURNAGAIN N.E. | A | 0A1 | 2,878.66 | 10,000.0 | 21,230.27 | 56,381.04 | 26,735.36 | 1,442.22 | 13,455.38 | 98,014.00 |
| 6 | 001-121-18 | TURNAGAIN N.E. | A | 1A2-1 | 2,607.89 | 10,000.0 | 20,796.97 | 55,222.40 | 41,139.40 | 1,306.56 | 12,531.58 | 110,199.94 |
| 7 | 001-132-07 | TURNAGAIN HTS | A | 43 | 0.00 | 0.0 | -1,011.32 | 0.00 | N/A | N/A | N/A | 0.00 |
| 8 | 001-132-08 | TURNAGAIN HTS | A | 42 | 0.00 | 0.0 | -28,133.43 | 0.00 | N/A | N/A | N/A | 0.00 |
| 9 | 001-132-22 | TURNAGAIN HTS | A2 | 23A | 0.00 | 0.0 | 20,518.39 | 42,043.69 | 17,740.56 | 317.79 | 9,040.61 | 69,142.65 |
| 10 | 001-132-23 | TURNAGAIN HTS | A2 | 22A | 0.00 | 0.0 | 20,518.39 | 42,043.69 | 17,740.56 | 317.79 | 9,040.61 | 69,142.65 |
| 11 | 001-132-32 | TURNAGAIN HTS | A2 | 13B | 0.00 | 0.0 | -62,111.24 | 0.00 | N/A | N/A | N/A | 0.00 |
| 12 | 001-132-37 | TURNAGAIN HTS | A2 | 34B | 0.00 | 0.0 | -1,777.80 | 0.00 | N/A | N/A | N/A | 0.00 |
| 13 | 001-132-38 | TURNAGAIN HTS | A2 | 35A | 0.00 | 0.0 | -5,421.22 | 0.00 | N/A | N/A | N/A | 0.00 |
| 14 | 001-132-39 | TURNAGAIN HTS | A2 | 36B | 0.00 | 0.0 | -8,287.53 | 0.00 | N/A | N/A | N/A | 0.00 |
| 15 | 001-132-41 | TURNAGAIN HTS | A2 | 37B | 0.00 | 0.0 | -8,287.53 | 0.00 | N/A | N/A | N/A | 0.00 |
| 16 | 001-132-45 | TURNAGAIN HTS | A2 | 29C | 0.00 | 0.0 | -11,289.39 | 0.00 | N/A | N/A | N/A | 0.00 |
| 17 | 001-132-46 | TURNAGAIN HTS | A2 | 30C | 0.00 | 0.0 | 10,761.30 | 22,050.69 | N/A | N/A | N/A | 22,050.69 |
| 18 | 001-132-58 | TURNAGAIN N.E. | A2 | 19B | 0.00 | 0.0 | 16,687.26 | 34,193.43 | 15,824.24 | 282.42 | 8,100.06 | 58,400.15 |
| 19 | 001-132-67 | TURNAGAIN HTS | A | 44A | 0.00 | 0.0 | -1,011.32 | 0.00 | N/A | N/A | N/A | 0.00 |
| 20 | 001-132-68 | TURNAGAIN HTS | A | 45A | 0.00 | 0.0 | -3,659.39 | 0.00 | N/A | N/A | 11,650.40 | 11,650.40 |
| 21 | 001-132-69 | TURNAGAIN HTS | A | 46A | N/A | N/A | N/A | N/A | N/A | N/A | 24,020.03 | 24,020.03 |
| 22 | 001-132-70 | TURNAGAIN N.E. | A2 | 18C1 | 847.18 | 0.0 | 22,850.47 | 47,669.48 | 23,518.75 | 424.44 | 11,876.62 | 83,489.29 |
| 23 | 001-132-71 | TURNAGAIN N.E. | A2 | 20B1 | 562.45 | 0.0 | 20,402.39 | 42,368.45 | 15,790.11 | 281.79 | 8,083.30 | 66,523.65 |
| 24 | 001-132-72 | TURNAGAIN N.E. | A2 | 21B1 | 561.19 | 10,000.0 | 20,501.98 | 52,571.26 | 15,755.98 | 281.16 | 8,066.55 | 76,674.95 |
| 25 | 001-132-73 | TURNAGAIN N.E. | A2 | 41B1 | 559.40 | 0.0 | 20,495.67 | 42,556.53 | 15,707.22 | 280.26 | 8,042.62 | 66,586.63 |
| 26 | 001-132-74 | TURNAGAIN N.E. | A2 | 40B1 | 668.32 | 0.0 | 25,430.88 | 52,778.07 | 18,663.77 | 334.83 | 9,493.73 | 81,270.40 |
| 27 | 001-132-77 | TURNAGAIN N.E. | A2 | 39B1 | 667.06 | 0.0 | 37,581.12 | 77,673.53 | 18,629.64 | 334.20 | 9,476.98 | 106,114.35 |
| 28 | 001-132-78 | TURNAGAIN N.E. | A | 2A2-1 | 3,473.81 | 0.0 | 22,605.13 | 49,793.38 | 54,808.77 | 1,740.39 | 16,562.63 | 122,905.17 |
| 29 | 001-132-79 | TURNAGAIN N.E. | A | 3A1 | 2,574.17 | 0.0 | 20,806.22 | 45,207.64 | 24,908.44 | 1,289.67 | 12,546.74 | 83,952.49 |
| 30 | 001-132-80 | TURNAGAIN N.E. | A | 4A1 | 2,556.51 | 10,000.0 | 20,806.22 | 55,189.98 | 24,908.44 | 1,280.82 | 12,546.74 | 93,925.98 |
| 31 | 001-132-81 | TURNAGAIN N.E. | A | 5A1 | 2,539.02 | 10,000.0 | 20,806.43 | 55,172.93 | 24,908.44 | 1,272.06 | 12,546.74 | 93,900.17 |
| 32 | 001-132-82 | TURNAGAIN N.E. | A | 6A1 | 2,521.06 | 0.0 | 20,806.22 | 45,154.53 | 24,908.44 | 1,263.06 | 12,546.74 | 83,872.77 |
| 33 | 001-132-83 | TURNAGAIN N.E. | A | 7A1 | 2,503.34 | 10,000.0 | 20,806.22 | 55,136.81 | 24,908.44 | 1,254.18 | 12,546.74 | 93,846.17 |
| 34 | 001-132-84 | TURNAGAIN N.E. | A | 8A1 | 2,485.61 | 10,000.0 | 20,806.43 | 55,119.52 | 24,908.44 | 1,245.30 | 12,546.74 | 93,820.00 |
| 35 | 001-132-90 | TURNAGAIN N.E. | A2 | 25B2 | 1,318.79 | 0.0 | -34,507.00 | 0.00 | N/A | N/A | N/A | 0.00 |
| 36 | 001-132-91 | TURNAGAIN N.E. | A | 10B | 7,343.73 | 0.0 | 62,410.47 | 135,227.37 | 74,713.95 | 3,679.23 | 37,634.63 | 251,255.18 |
| 37 | 001-193-31 | LYN'ARY | | Park Site | 0.00 | 0.0 | -406,299.01 | 0.00 | N/A | N/A | N/A | 0.00 |
| TOTALS | | | | | 47,499.80 | 100,000.0 | 0.00 | 1,317,833.32 | 605,139.18 | 24,054.84 | 321,263.14 | 2,268,290.48 |

INDICATES PROPERTY DELETED.

ALL PARCELS S.M., ALASKA

TURNAGAIN L.I.D. No. 101

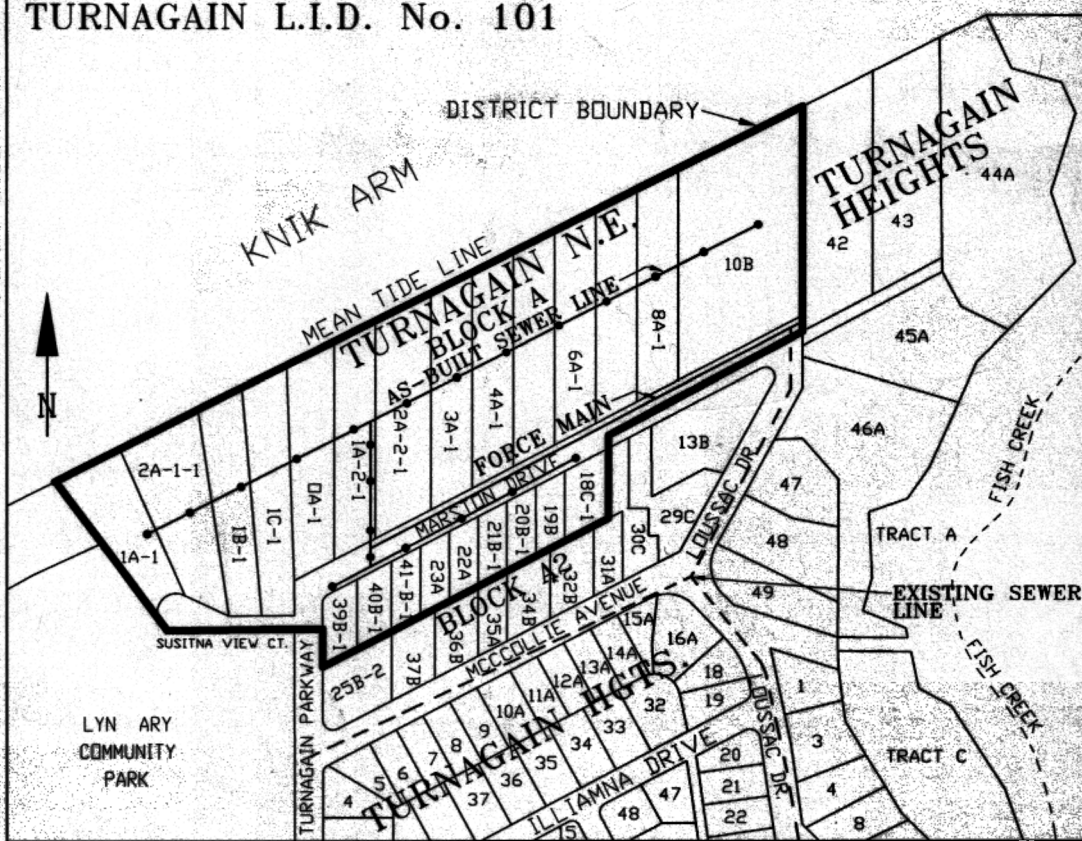

TURNAGAIN L.I.D. No. 101

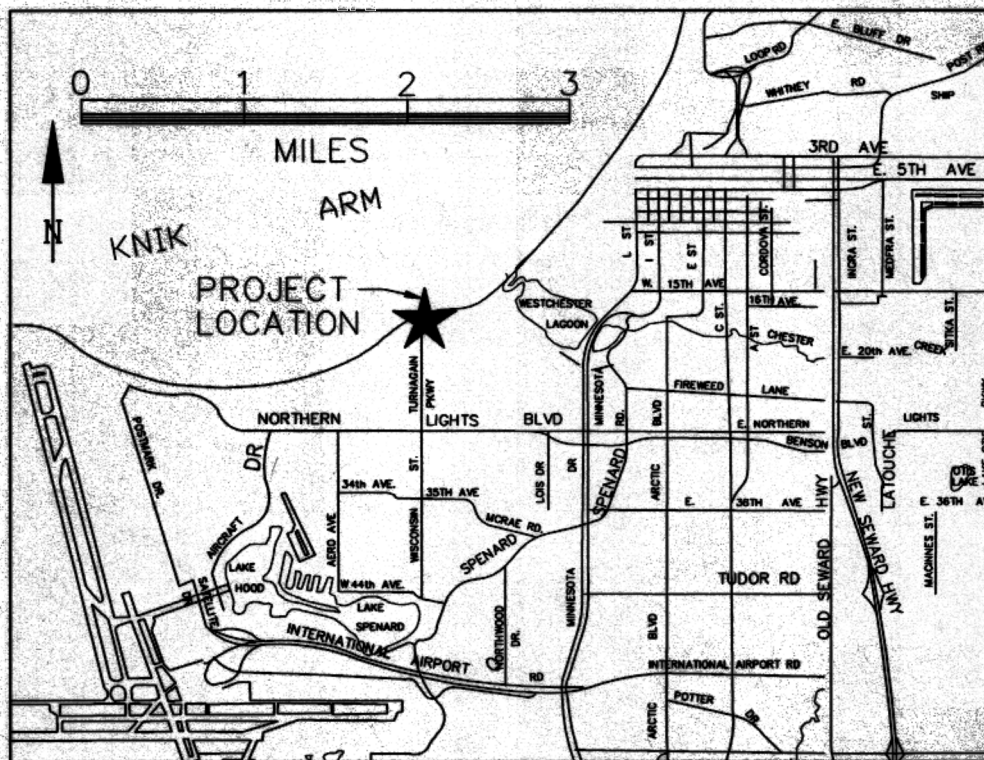

LOCATION MAP

ANCHORAGE
RECORDING DISTRICT

043944

23-

1999 JL -9 AM 11:26

REQUESTED BY
MOA

RETURN TO:
Anchorage Water & Wastewater Utility
Private Development
3000 Arctic Boulevard
Anchorage, Alaska 99503-3888
(907) 564-2747

ALL PARCELS 5 M ALASKA

PROJECT COST \$605,139.21
TRUNK RATE \$.0300000/SQ.FT.
LATERAL RATE \$1.6253711868/SQ.FT.
INTEREST RATE 07.320000%
PUC CALCULATION 021

| BOOK-PAGE-LOT | SQ/FT | | ASSESSMENT | TOTAL-ASMT | ANNUAL PAYMENT | # OF PMTS | TOT-ANN PAYMENTS | FINAL PAYMENT | NAME ADDRESS |
|----------------|--------|-----------|------------|------------|----------------|-----------|------------------|---------------|-------------------------|
| 001-132-72-000 | 9,372 | LAT: | 15,232.98 | 15,755.98 | 1,420.47 | 20 | | 1,420.47 | IGNATIEV ALEXANDER G |
| BLK A2 LT 21B1 | | SVC CONN: | 523.00 | | | | 1,701.63 | | |
| TURNAGAIN N E | 9,372 | TRUNK: | | 281.16 | 281.16 | | | 281.16 | |
| 001-132-71-000 | 9,393 | LAT: | 15,267.11 | 15,790.11 | 1,423.54 | 20 | | 1,423.54 | BURCHAM ROBERT |
| BLK A2 LT 20B1 | | SVC CONN: | 523.00 | | | | 1,705.33 | | |
| TURNAGAIN N E | 9,393 | TRUNK: | | 281.79 | 281.79 | | | 281.79 | |
| 001-132-58-000 | 9,414 | LAT: | 15,301.24 | 15,824.24 | 426.62 | 20 | | 1,426.62 | CROFT CHANCY & TOMI |
| BLK A2 LT 19B | | SVC CONN: | 523.00 | | | | 1,709.04 | | |
| TURNAGAIN N E | 9,414 | TRUNK: | | 282.42 | 282.42 | | | 282.42 | |
| 001-132-70-000 | 14,148 | LAT: | 22,995.75 | 23,518.75 | 2,120.31 | 20 | | 2,120.31 | CROFT CHANCY & TOMI |
| BLK A2 LT 18C1 | | SVC CONN: | 523.00 | | | | 2,544.75 | | |
| TURNAGAIN N E | 14,148 | TRUNK: | | 424.44 | 424.44 | | | 424.44 | |
| 001-132-78-000 | 33,399 | LAT: | 54,285.77 | 54,808.77 | 4,941.24 | 20 | | 4,941.24 | ATWOOD ROBERT B |
| BLK A LT 2A2-1 | | SVC CONN: | 523.00 | | | | 5,340.15 | | RESIDUARY TRUST UTA |
| TURNAGAIN N E | 58,013 | TRUNK: | | 1,740.39 | 398.91 | 5 | | 398.91 | |
| 001-132-79-000 | 15,003 | LAT: | 24,385.44 | 24,908.44 | 2,245.60 | 20 | | 2,245.60 | ATWOOD ROBERT B |
| BLK A LT 3A1 | | SVC CONN: | 523.00 | | | | 2,541.20 | | LIVING TRUST 50% & |
| TURNAGAIN N E | 42,989 | TRUNK: | | 1,289.67 | 295.60 | 5 | | 295.60 | RESIDUARY TRUST UTA 50% |
| 001-132-80-000 | 15,003 | LAT: | 24,385.44 | 24,908.44 | 2,245.60 | 20 | | 2,245.60 | URIG SUSAN L |
| BLK A LT 4A1 | | SVC CONN: | 523.00 | | | | 2,539.17 | | |
| TURNAGAIN N E | 42,694 | TRUNK: | | 1,280.82 | 293.57 | 5 | | 293.57 | |
| 001-132-81-000 | 5,003 | LAT: | 24,385.44 | 24,908.44 | 2,245.60 | 20 | | 2,245.60 | URIG SUSAN L |
| BLK A LT 5A1 | | SVC CONN: | 523.00 | | | | 2,537.16 | | |
| TURNAGAIN N E | 2,402 | TRUNK: | | 1,272.06 | 291.56 | 5 | | 291.56 | |
| 001-132-82-000 | 5,003 | LAT: | 24,385.44 | 24,908.44 | 245.60 | 20 | | 2,245.60 | DANNER FRANK A & |
| BLK A LT 6A1 | | SVC CONN: | 523.00 | | | | 2,535.10 | | MARIE-FRANCE J |
| TURNAGAIN N E | 2,102 | TRUNK: | | 1,263.06 | 289.50 | 5 | | 289.50 | |
| 001-132-83-000 | 5,003 | LAT: | 24,385.44 | 24,908.44 | 245.60 | 20 | | 2,245.60 | NELSON DANIEL D |
| BLK A LT 7A1 | | SVC CONN: | 523.00 | | | | 2,533.07 | | |
| TURNAGAIN N E | 1,806 | TRUNK: | | 1,254.18 | 287.47 | 5 | | 287.47 | |
| 001-132-84-000 | 5,003 | LAT: | 24,385.44 | 24,908.44 | 245.60 | 20 | | 2,245.60 | RASMUSON EDWARD B & |
| BLK A LT 8A1 | | SVC CONN: | 523.00 | | | | 2,531.03 | | CATHRYN R 50% & |
| TURNAGAIN N E | 1,510 | TRUNK: | | 1,245.30 | 285.43 | | | 285.43 | NELSON DANIEL D 50% |

ALL PARCELS S.M., ALASKA

REPORT NUMBER FSA045-A
OCTOBER 06, 1997

WATER AND WASTEWATER UTILITY
SEWER FINAL ASSESSMENTS FOR LID NUMBER 94101 N.E. TURNAGAIN LID #101

PAGE

PROJECT COST \$605,139.21
TRUNK RATE \$.0300000/SQ.FT.
LATERAL RATE \$1.6253711868/SQ.FT.
INTEREST RATE 07.320000%
PUC CALCULATION 021

| BOOK-PAGE-LOT | SQ/FT | | ASSESSMENT | TOTAL-ASMT | ANNUAL # OF PAYMENT PMTS | TOT-ANN PAYMENTS | FINAL PAYMENT | NAME ADDRESS |
|----------------|---------|-----------|------------|------------|-----------------------------|---------------------|------------------|------------------------------|
| 001-132-91-000 | 45,002 | LAT: | 73,144.95 | 74,713.95 | 6,735.77 20 | | 6,735.77 | RASHUSON FAMILY LIVING TRUST |
| BLK A LT 10B | | SVC CONN: | 1,569.00 | | | 7,231.13 | | RASHUSON CATHRYN R & |
| TURNAGAIN N E | 122,641 | TRUNK: | | 3,679.23 | 495.36 10 | | 495.36 | EDWARD B/TRUSTEES |

REPORT TOTALS FOLLOW *****

| | | | | | | | | |
|--------|--------|-----------|------------|------------|-----------|--|-----------|--|
| REPORT | 64,264 | LAT: | 592,064.18 | 605,139.18 | 54,555.79 | | 54,555.79 | |
| | | SVC CONN: | 13,075.00 | | | | | |

| | | | | | | | | |
|---------|--------|--------|--|-----------|----------|-----------|---------|--|
| TOTALS: | 01,828 | TRUNK: | | 24,054.84 | 7,365.95 | 61,921.74 | ,365.95 | |
|---------|--------|--------|--|-----------|----------|-----------|---------|--|

TOTAL ITEMS

ALL PARCELS S.M. ALASKA

**COMBINED PW AWWU
SUMMARY ASSESSMENT ROLL FOR NE TURNAGAIN**

By: Mark S.
November 10, 1997

| PROPERTY DESCRIPTION | | | | | Public Works | | | | Anchorage Water & Wastewater | | | TOTAL ASSMTS | | PROPERTY OWNERS |
|----------------------|-------------|-----------|------|------------------|--------------------------|-------------------|-------------------|------------------|------------------------------|------------|-----------|-----------------|--------------|--------------------|
| | | | | | Street Improvement Costs | | | | Wastewater | | | | | |
| Tax ID | SUBDIVISION | Blk | Lot | DIRECT REPLAT | SOILS | DELETION COSTS | RID COST TOTAL | Lateral Sewer | Trunk Sewer | Water | | | | |
| 1 | 001-121-13 | TURNAGAIN | N.E. | A | 1A1 | 2,414.36 | 10,000.0 | 19,869.54 | 53,128.51 | 24,715.02 | 1,209.60 | 12,857.37 | 91,910.50 | OSENGA |
| 2 | 001-121-14 | TURNAGAIN | N.E. | A | 2A-1-1 | 3,238.42 | 10,000.0 | 23,841.58 | 62,091.57 | 29,498.49 | 1,622.46 | 16,607.61 | 109,820.13 | SHEFFIELD |
| 3 | 001-121-15 | TURNAGAIN | N.E. | A | 1B1 | 2,497.35 | 10,000.0 | 23,795.04 | 61,255.14 | 22,026.66 | 1,251.18 | 9,797.98 | 94,330.96 | CHUNG |
| 4 | 001-121-16 | TURNAGAIN | N.E. | A | 1C1 | 2,681.48 | 0.0 | 36,661.57 | 77,803.71 | 22,680.06 | 1,343.43 | 9,644.01 | 111,471.21 | BEAN |
| 5 | 001-121-17 | TURNAGAIN | N.E. | A | 0A1 | 2,878.66 | 10,000.0 | 21,230.27 | 56,381.04 | 26,735.36 | 1,442.22 | 13,455.38 | 98,014.00 | PUGH |
| 6 | 001-121-18 | TURNAGAIN | N.E. | A | 1A2-1 | 2,607.89 | 10,000.0 | 20,796.97 | 55,222.40 | 41,139.40 | 1,306.56 | 12,531.58 | 110,199.94 | MAGUIRE |
| 7 | 001-132-07 | TURNAGAIN | HTS | A | 43 | 0.00 | 0.0 | -1,011.32 | 0.00 | N/A | N/A | N/A | 0.00 | SWALLING AC |
| 8 | 001-132-08 | TURNAGAIN | HTS | A | 42 | 0.00 | 0.0 | -28,133.43 | 0.00 | N/A | N/A | N/A | 0.00 | MARTIN |
| 9 | 001-132-22 | TURNAGAIN | HTS | A2 | 23A | 0.00 | 0.0 | 20,518.39 | 42,043.69 | 17,740.56 | 317.79 | 9,040.61 | 69,142.65 | RENTSCHLER C |
| 10 | 001-132-23 | TURNAGAIN | HTS | A2 | 22A | 0.00 | 0.0 | 20,518.39 | 42,043.69 | 17,740.56 | 317.79 | 9,040.61 | 69,142.65 | RENTSCHLER C |
| 11 | 001-132-32 | TURNAGAIN | HTS | A2 | 13B | 0.00 | 0.0 | -62,111.24 | 0.00 | N/A | N/A | N/A | 0.00 | WALSH |
| 12 | 001-132-37 | TURNAGAIN | HTS | A2 | 34B | 0.00 | 0.0 | -1,777.80 | 0.00 | N/A | N/A | N/A | 0.00 | RICHMOND |
| 13 | 001-132-38 | TURNAGAIN | HTS | A2 | 35A | 0.00 | 0.0 | -5,421.22 | 0.00 | N/A | N/A | N/A | 0.00 | KEMPPPEL |
| 14 | 001-132-39 | TURNAGAIN | HTS | A2 | 36B | 0.00 | 0.0 | -8,287.53 | 0.00 | N/A | N/A | N/A | 0.00 | RENTSCHLER M |
| 15 | 001-132-41 | TURNAGAIN | HTS | A2 | 37B | 0.00 | 0.0 | -8,287.53 | 0.00 | N/A | N/A | N/A | 0.00 | MEHNER |
| 16 | 001-132-45 | TURNAGAIN | HTS | A2 | 29C | 0.00 | 0.0 | -11,289.39 | 0.00 | N/A | N/A | N/A | 0.00 | SASSARA |
| 17 | 001-132-46 | TURNAGAIN | HTS | A2 | 30C | 0.00 | 0.0 | 10,761.30 | 22,050.69 | N/A | N/A | N/A | 22,050.69 | CHRISTOPHERSON |
| 18 | 001-132-58 | TURNAGAIN | N.E. | A2 | 19B | 0.00 | 0.0 | 16,687.26 | 34,193.43 | 15,824.24 | 282.42 | 8,100.06 | 58,400.15 | CROFT |
| 19 | 001-132-67 | TURNAGAIN | HTS | A | 44A | 0.00 | 0.0 | -1,011.32 | 0.00 | N/A | N/A | N/A | 0.00 | SWALLING AC |
| 20 | 001-132-68 | TURNAGAIN | HTS | A | 45A | 0.00 | 0.0 | -3,659.39 | 0.00 | N/A | N/A | 11,650.40 | 11,650.40 | SWALLING J |
| 21 | 001-132-69 | TURNAGAIN | HTS | A | 46A | N/A | N/A | N/A | N/A | N/A | N/A | 24,020.03 | 24,020.03 | HICKEL |
| 22 | 001-132-70 | TURNAGAIN | N.E. | A2 | 18C1 | 847.18 | 0.0 | 22,850.47 | 47,669.48 | 23,518.75 | 424.44 | 11,876.62 | 83,489.29 | CROFT |
| 23 | 001-132-71 | TURNAGAIN | N.E. | A2 | 20B1 | 562.45 | 0.0 | 20,402.39 | 42,368.45 | 15,790.11 | 281.79 | 8,083.30 | 66,523.65 | BURCHAM |
| 24 | 001-132-72 | TURNAGAIN | N.E. | A2 | 21B1 | 561.19 | 10,000.0 | 20,501.98 | 52,571.26 | 15,755.98 | 281.16 | 8,066.55 | 76,674.95 | IGNATIEV |
| 25 | 001-132-73 | TURNAGAIN | N.E. | A2 | 41B1 | 559.40 | 0.0 | 20,495.67 | 42,556.53 | 15,707.22 | 280.26 | 8,042.62 | 66,586.63 | INGRIM |
| 26 | 001-132-74 | TURNAGAIN | N.E. | A2 | 40B1 | 668.32 | 0.0 | 25,430.88 | 52,778.07 | 18,663.77 | 334.83 | 9,493.73 | 81,270.40 | MARSTON |
| 27 | 001-132-77 | TURNAGAIN | N.E. | A2 | 39B1 | 667.06 | 0.0 | 37,581.12 | 77,673.53 | 18,629.64 | 334.20 | 9,476.98 | 106,114.35 | MARSTON |
| 28 | 001-132-78 | TURNAGAIN | N.E. | A | 2A2-1 | 3,473.81 | 0.0 | 22,605.13 | 49,793.38 | 54,808.77 | 1,740.39 | 16,562.63 | 122,905.17 | ATWOOD |
| 29 | 001-132-79 | TURNAGAIN | N.E. | A | 3A1 | 2,574.17 | 0.0 | 20,806.22 | 45,207.64 | 24,908.44 | 1,289.67 | 12,546.74 | 83,952.49 | ATWOOD |
| 30 | 001-132-80 | TURNAGAIN | N.E. | A | 4A1 | 2,556.51 | 10,000.0 | 20,806.22 | 55,189.98 | 24,908.44 | 1,280.82 | 12,546.74 | 93,925.98 | URIG |
| 31 | 001-132-81 | TURNAGAIN | N.E. | A | 5A1 | 2,539.02 | 10,000.0 | 20,806.43 | 55,172.93 | 24,908.44 | 1,272.06 | 12,546.74 | 93,900.17 | URIG |
| 32 | 001-132-82 | TURNAGAIN | N.E. | A | 6A1 | 2,521.06 | 0.0 | 20,806.22 | 45,154.53 | 24,908.44 | 1,263.06 | 12,546.74 | 83,872.77 | DANNER |
| 33 | 001-132-83 | TURNAGAIN | N.E. | A | 7A1 | 2,503.34 | 10,000.0 | 20,806.22 | 55,136.81 | 24,908.44 | 1,254.18 | 12,546.74 | 93,846.17 | NELSON |
| 34 | 001-132-84 | TURNAGAIN | N.E. | A | 8A1 | 2,485.61 | 10,000.0 | 20,806.43 | 55,119.52 | 24,908.44 | 1,245.30 | 12,546.74 | 93,820.00 | RASMUSON |
| 35 | 001-132-90 | TURNAGAIN | N.E. | A2 | 25B2 | 1,318.79 | 0.0 | -34,507.00 | 0.00 | N/A | N/A | N/A | 0.00 | POSPISIL |
| 36 | 001-132-91 | TURNAGAIN | N.E. | A | 10B | 7,343.73 | 0.0 | 62,410.47 | 135,227.37 | 74,713.95 | 3,679.23 | 37,634.63 | 251,255.18 | RASMUSON |
| 37 | 001-193-31 | LYN ARY | | | Park Site | 0.00 | 0.0 | -406,299.01 | 0.00 | N/A | N/A | N/A | 0.00 | MOA |
| TOTALS | | | | | | 47,499.80 | 100,000.0 | 0.00 | 1,317,833.32 | 605,139.18 | 24,054.84 | 321,263.14 | 2,268,290.48 | |

INDICATES PROPERTY DELETED.

ALL PARCELS S.M., ALASKA